

Glass Type:

Reflex+ High performance triple glazed unit

Glass Colour Options:

Reflex+ (Clear, Blue, Bronze or Opaque)

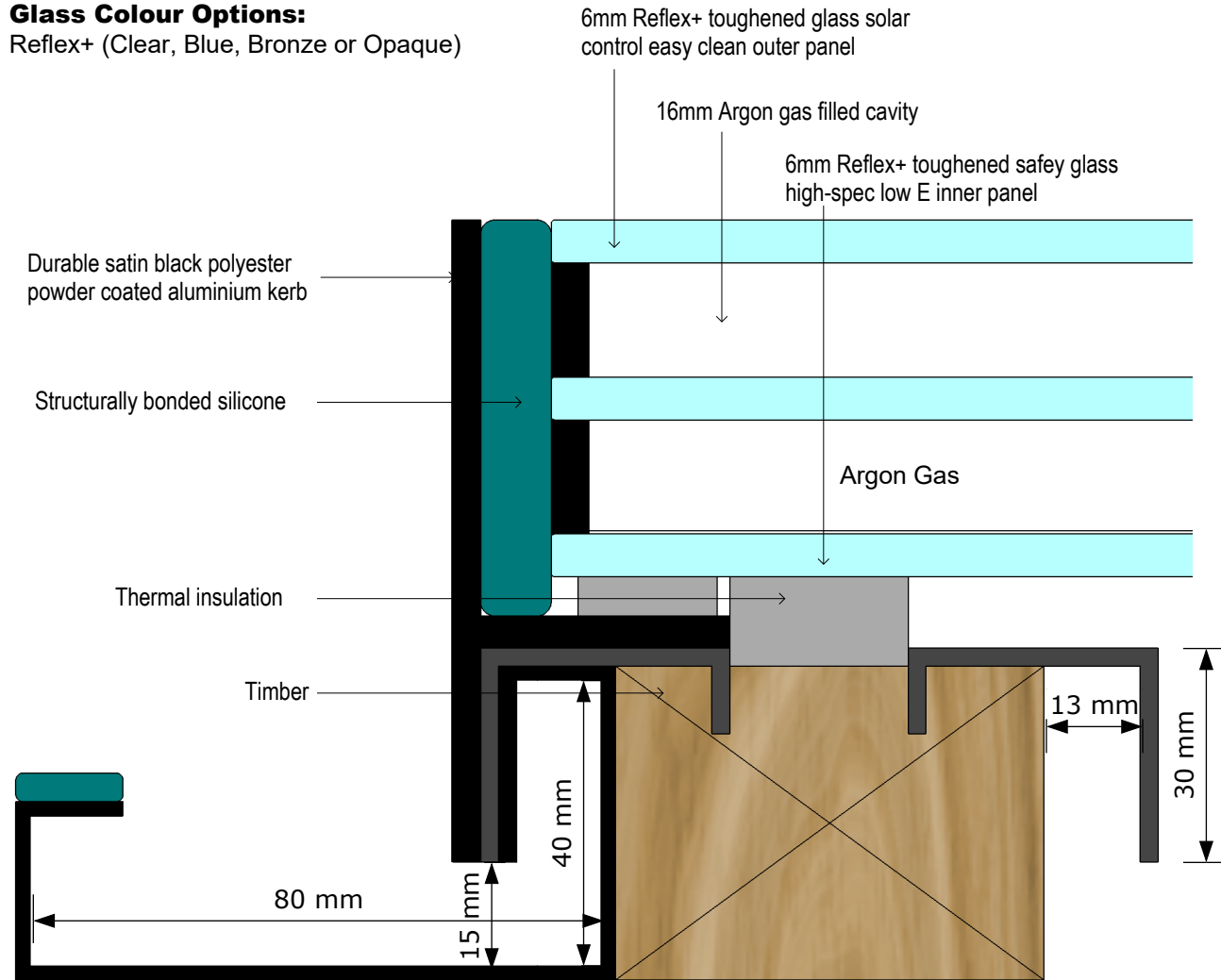

TECHNICAL DETAILS - LUXLITE SKYLIGHT

- Light Transmission of Clear glass = 70%
- Light Transmission of Blue glass = 40%
- Light Transmission of Bronze glass = 70%
- Light Transmission of Opaque/Obscure glass = 70%
- UV Blocked = 90%
- Spaces bar system = warm edge no metallic, Tri-seal/Super spacer desiccant impregnated
- Toughened to BS EN 12150
- Manufactured to BS EN1279 Part 2 & 3
- Structural Frame = A satin black durable polyester powder coated aluminium integrated upstand featuring a two part (inner/outer) profile joined by resin thermal breaks creating a triple cavity and expanded polystyrene insert from added insulation



ROOF maker

1 Pinfold Road, Thurmaston
Leicester, LE4 8AS

Tel: 0116 269 6297

Fax: 0116 269 6291

Email: sales@roof-maker.co.uk

Title:

LUXLITE SKYLIGHT (FIXED) - PRODUCT SPECIFICATION

THIS DRAWING IS FOR REFERENCE ONLY. PLEASE REPORT ANY DISCREPANCIES TO THE DESIGNER BEFORE ANY WORKS COMMENCE.
ALL DIMENSIONS TO BE CHECKED ON SITE BEFORE ANY WORKS COMMENCE.

Reference: RM-Luxlite-F

Date: 06/02/2017

Drawn: TH Checked SS

Scale: Approx. 1:1 @ A4

Revision No: X

Glass Type:

Reflex+ High performance triple glazed unit

Glass Colour Options:

Reflex+ (Clear, Blue, Bronze or Opaque)

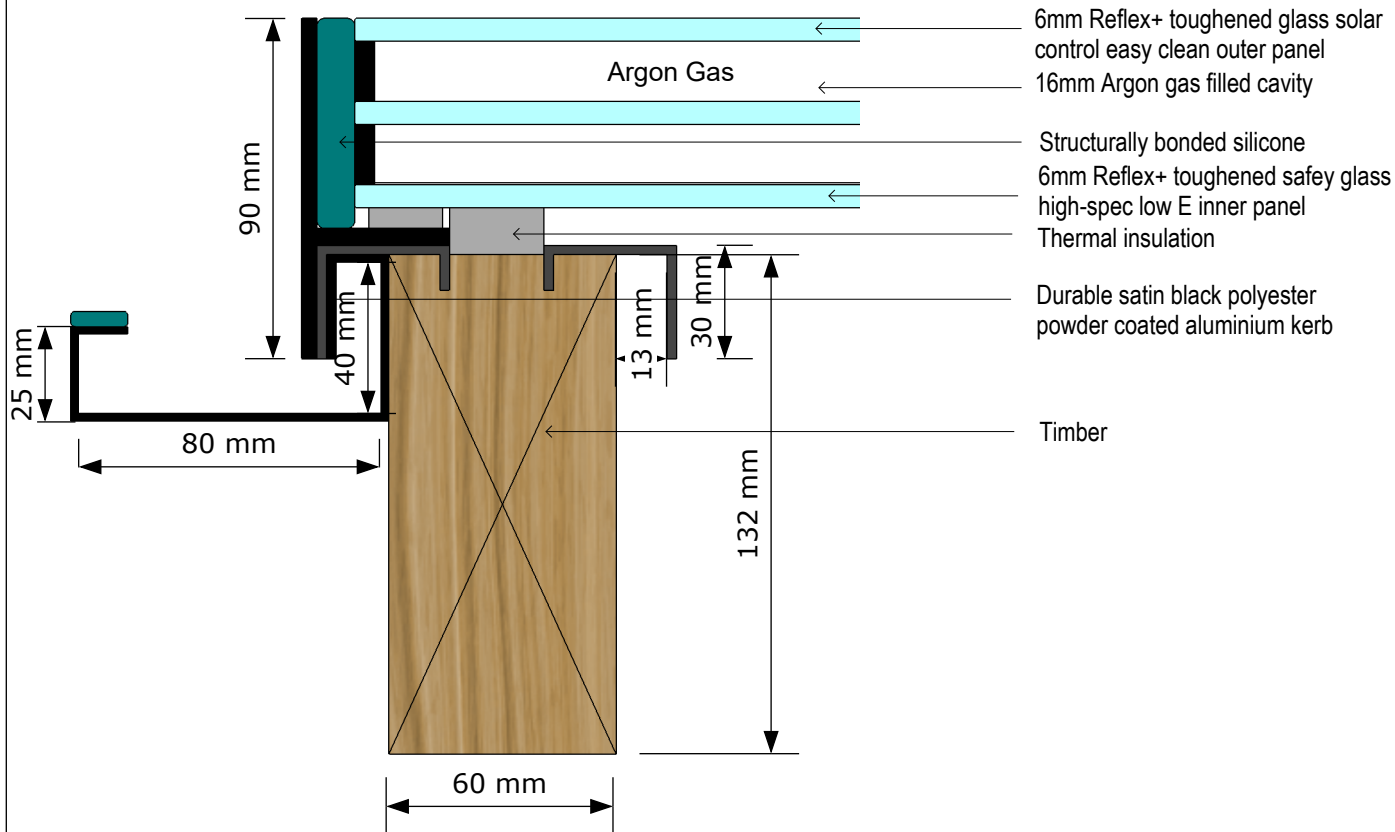

TECHNICAL DETAILS - LUXLITE SKYLIGHT

- Light Transmission of Clear glass = 70%
- Light Transmission of Blue glass = 40%
- Light Transmission of Bronze glass = 70%
- Light Transmission of Opaque/Obscure glass = 70%
- UV Blocked = 90%
- Spaces bar system = warm edge no metallic, Tri-seal/Super spacer desiccant impregnated
- Toughened to BS EN 12150
- Manufactured to BS EN1279 Part 2 & 3
- Structural Frame = A satin black durable polyester powder coated aluminium integrated upstand featuring a two part (inner/outer) profile joined by resin thermal breaks creating a triple cavity and expanded polystyrene insert from added insulation



ROOF maker

1 Pinfold Road , Thurmaston
Leicester, LE4 8AS

Tel: 0116 269 6297

Fax: 0116 269 6291

Email: sales@roof-maker.co.uk

Title:

LUXLITE SKYLIGHT (HINGED OPENER) - PRODUCT SPECIFICATION

THIS DRAWING IS FOR REFERENCE ONLY. PLEASE REPORT ANY DISCREPANCIES TO THE DESIGNER BEFORE ANY WORKS COMMENCE.
ALL DIMENSIONS TO BE CHECKED ON SITE BEFORE ANY WORKS COMMENCE.

Reference: RM-Luxlite-H

Date: 06/02/2017

Drawn: TH Checked SS

Scale: Approx. 1:2 @ A4

Revision No: X