

## TECHNICAL DETAILS - BI-FOLDING DOOR

- Light Transmission of Clear glass = 70%
- Light Transmission of Blue glass = 40%
- Light Transmission of Bronze glass = 70%
- Light Transmission of Opaque/Obscure glass = 70%
- UV Blocked = 90%
- Spaces bar system = warm edge no metallic, Tri-seal/Super spacer desiccant impregnated
- Toughened to BS EN 12150
- Manufactured to BS EN1279 Part 2 & 3

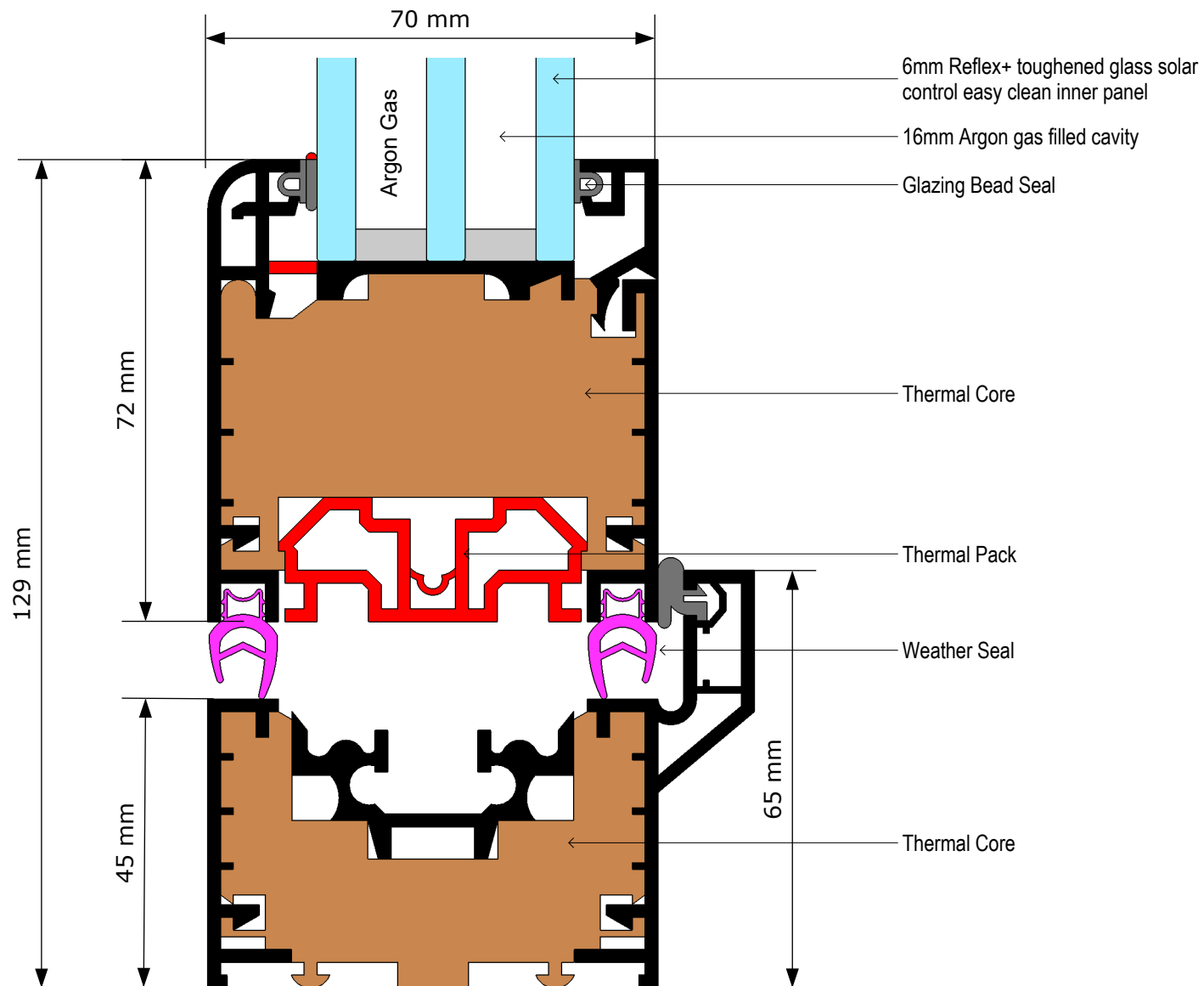

## TECHNICAL DETAILS - BI-FOLDING DOOR

- Light Transmission of Clear glass = 70%
- Light Transmission of Blue glass = 40%
- Light Transmission of Bronze glass = 70%
- Light Transmission of Opaque/Obscure glass = 70%
- UV Blocked = 90%
- Spaces bar system = warm edge no metallic, Tri-seal/Super spacer desiccant impregnated
- Toughened to BS EN 12150
- Manufactured to BS EN1279 Part 2 & 3

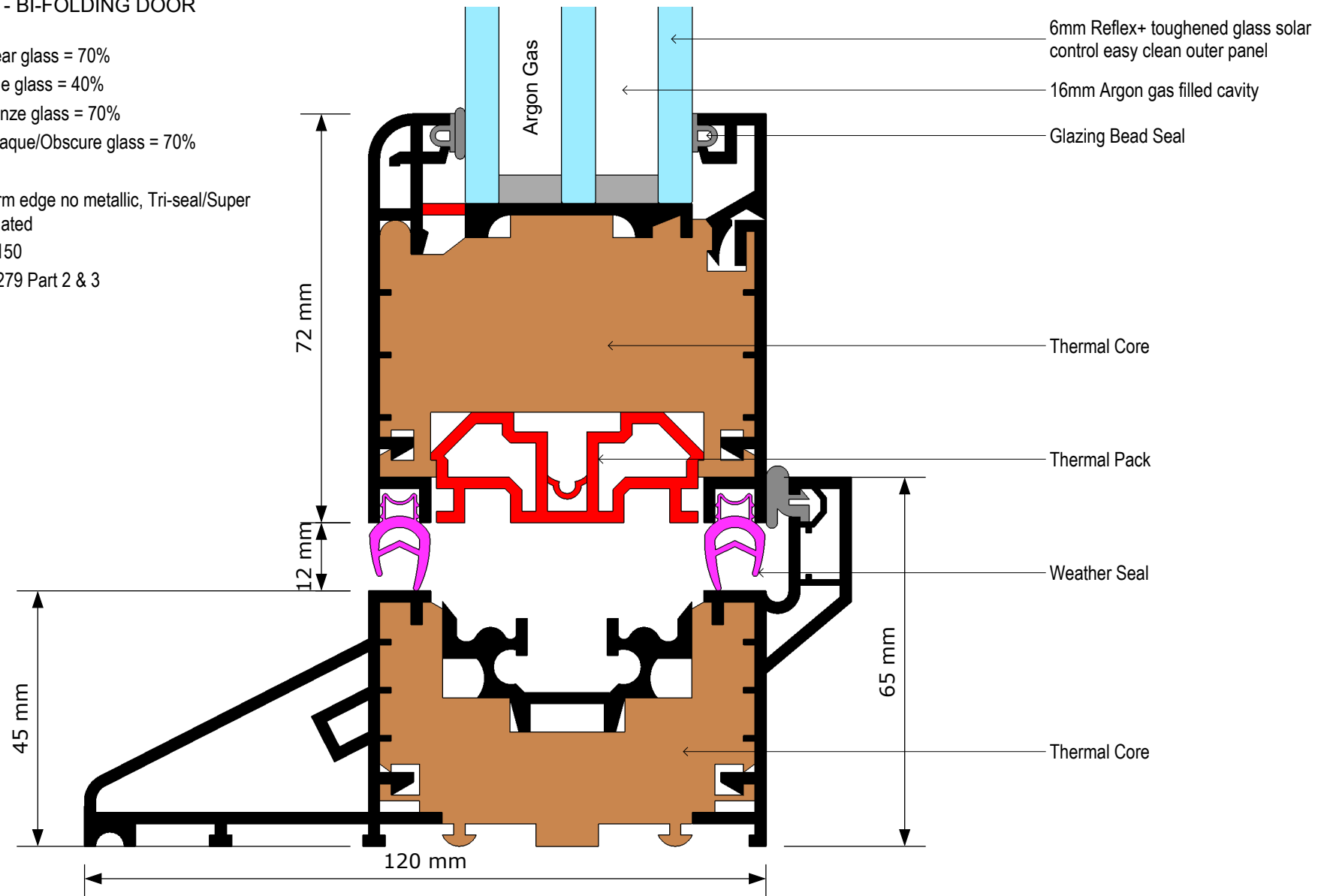

## TECHNICAL DETAILS - BI-FOLDING DOOR

- Light Transmission of Clear glass = 70%
- Light Transmission of Blue glass = 40%
- Light Transmission of Bronze glass = 70%
- Light Transmission of Opaque/Obscure glass = 70%
- UV Blocked = 90%
- Spaces bar system = warm edge no metallic, Tri-seal/Super spacer desiccant impregnated
- Toughened to BS EN 12150
- Manufactured to BS EN1279 Part 2 & 3

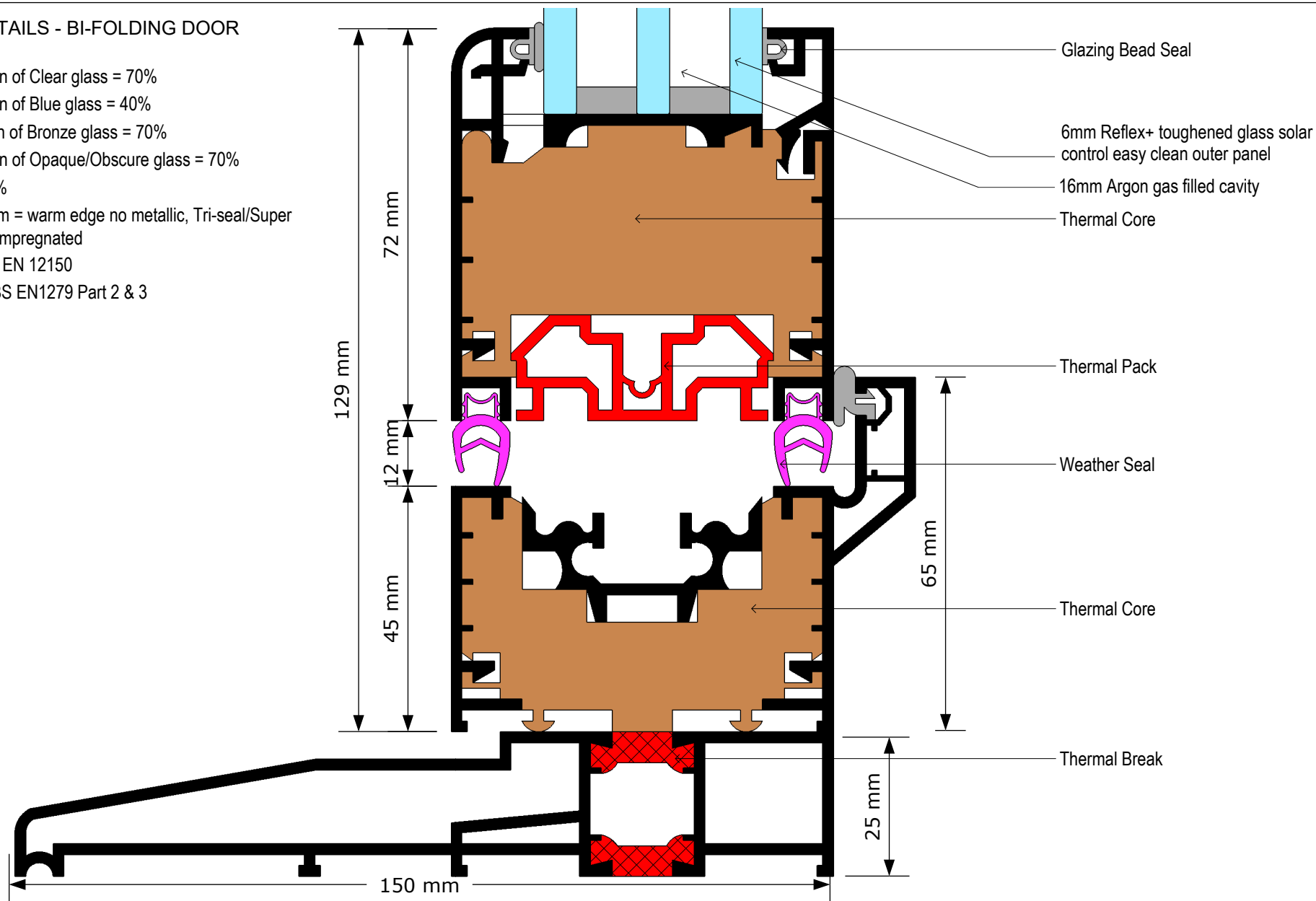

**ROOF maker**  
 OPENING UP NEW PERSPECTIVES

**ROOF maker**  
 1 Pinfold Road, Thurmaston  
 Leicester, LE4 8AS  
 Tel: 0116 269 6297  
 Fax: 0116 269 6291  
 Email: sales@roof-maker.co.uk

### Title: BI-FOLDING DOOR - C - 150mm SILL- PRODUCT SPECIFICATIONS

THIS DRAWING IS FOR REFERENCE ONLY. PLEASE REPORT ANY DISCREPANCIES TO THE DESIGNER BEFORE ANY WORKS COMMENCE.  
 ALL DIMENSIONS TO BE CHECKED ON SITE BEFORE ANY WORKS COMMENCE.

Reference: RM-BIFOLD-C  
 Date: 17/03/2017  
 Drawn: TH Checked SS

Scale: Approx. 1:1 @ A4  
 Revision No: X

## TECHNICAL DETAILS - BI-FOLDING DOOR

- Light Transmission of Clear glass = 70%
- Light Transmission of Blue glass = 40%
- Light Transmission of Bronze glass = 70%
- Light Transmission of Opaque/Obscure glass = 70%
- UV Blocked = 90%
- Spaces bar system = warm edge no metallic, Tri-seal/Super spacer desiccant impregnated
- Toughened to BS EN 12150
- Manufactured to BS EN1279 Part 2 & 3

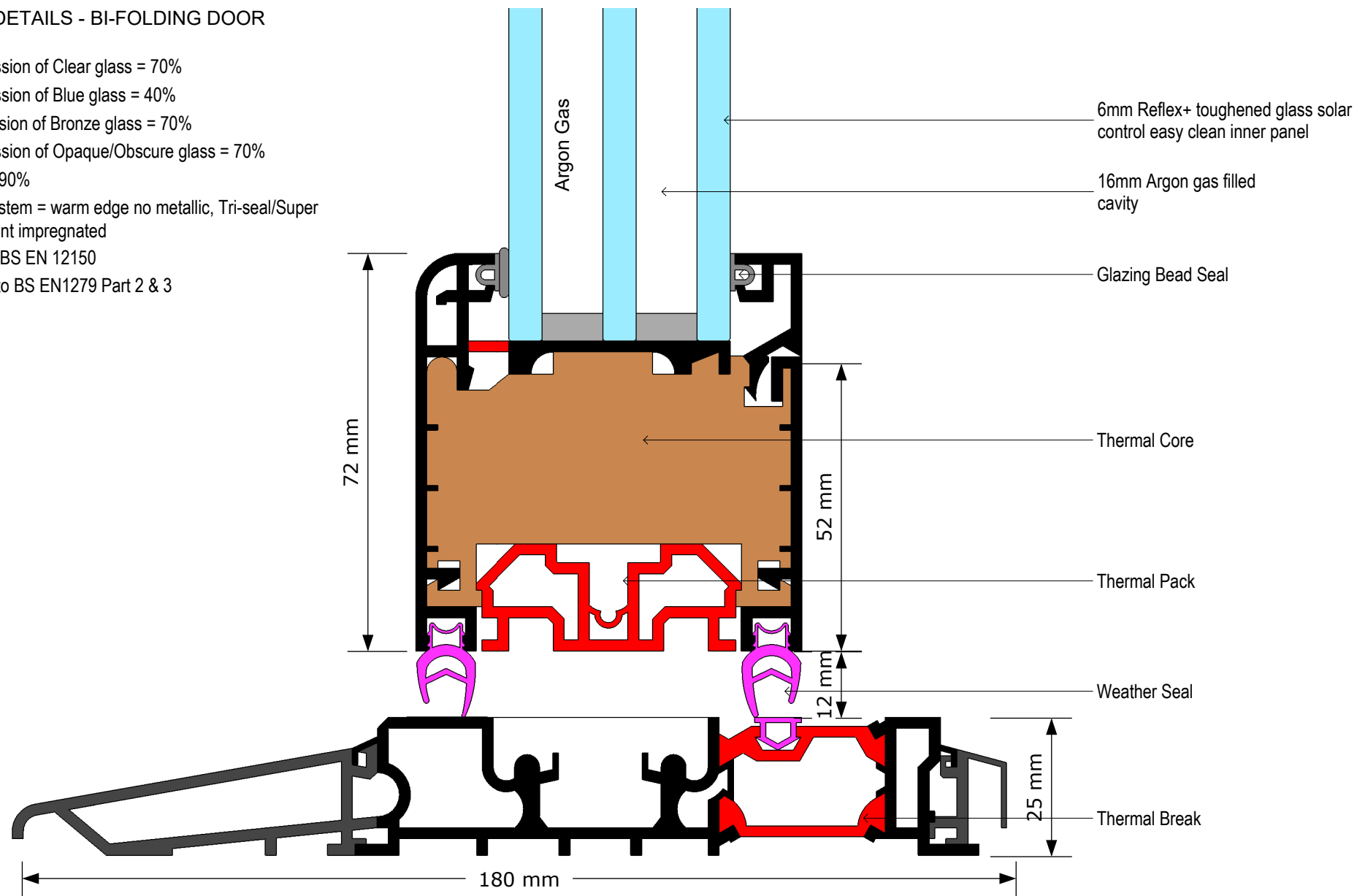

**ROOF**maker  
OPENING UP NEW PERSPECTIVES

**ROOF maker**  
1 Pinfold Road , Thurmaston  
Leicester, LE4 8AS  
Tel: 0116 269 6297  
Fax: 0116 269 6291  
Email: sales@roof-maker.co.uk

### Title: BI-FOLDING DOOR - D - LOW THRESHOLD- PRODUCT SPECIFICATIONS

THIS DRAWING IS FOR REFERENCE ONLY. PLEASE REPORT ANY DISCREPANCIES TO THE DESIGNER BEFORE ANY WORKS COMMENCE.  
ALL DIMENSIONS TO BE CHECKED ON SITE BEFORE ANY WORKS COMMENCE.

Reference: RM-BIFOLD-D  
Date: 17/03/2017  
Drawn: TH Checked SS

Scale: Approx. 1:1 @ A4  
Revision No: X

## TECHNICAL DETAILS - BI-FOLDING DOOR

- Light Transmission of Clear glass = 70%
- Light Transmission of Blue glass = 40%
- Light Transmission of Bronze glass = 70%
- Light Transmission of Opaque/Obscure glass = 70%
- UV Blocked = 90%
- Spaces bar system = warm edge no metallic, Tri-seal/Super spacer desiccant impregnated
- Toughened to BS EN 12150
- Manufactured to BS EN1279 Part 2 & 3

