

Glass Type:

Reflex+ High performance triple glazed unit

Glass Colour Options:

Reflex+ (Clear, Blue, Bronze or Opaque)

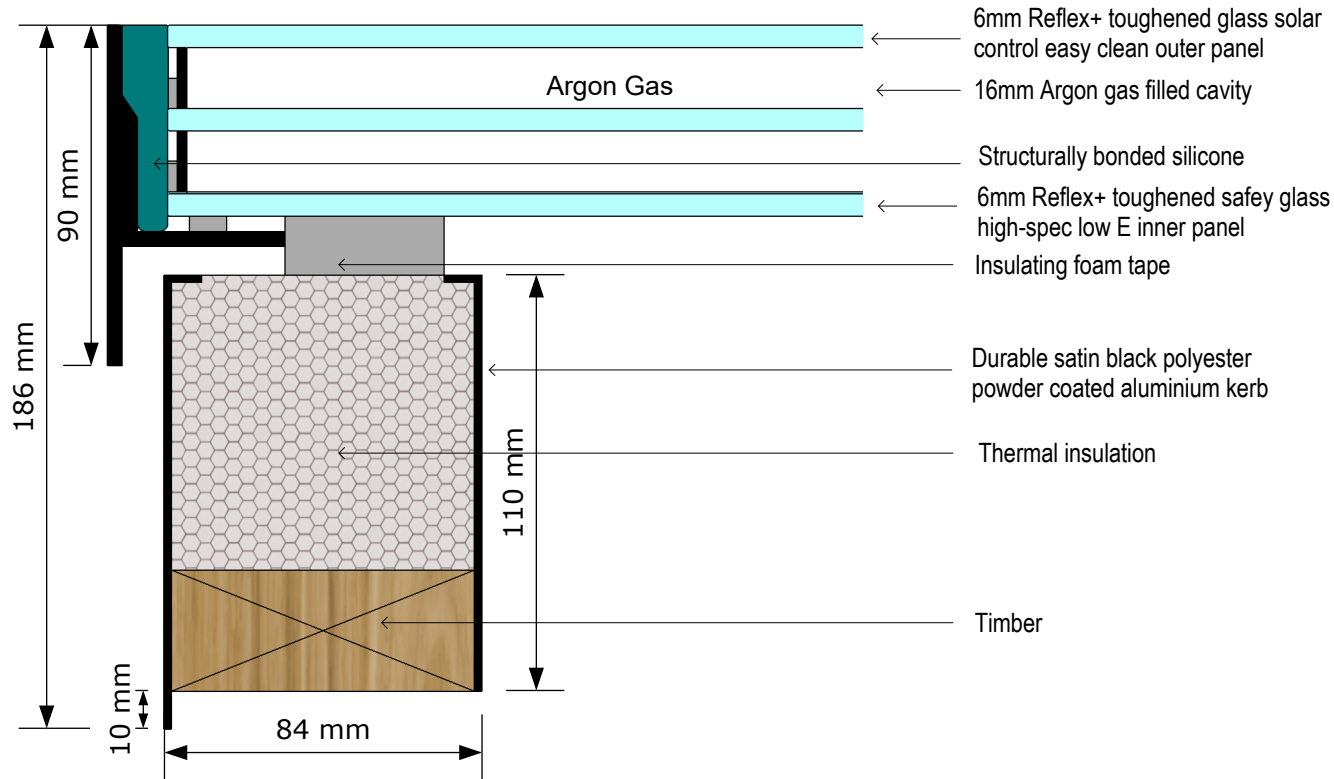

TECHNICAL DETAILS - HINGED OPENER SKYLIGHT

- Light Transmission of Clear glass = 70%
- Light Transmission of Blue glass = 40%
- Light Transmission of Bronze glass = 70%
- Light Transmission of Opaque/Obscure glass = 70%
- UV Blocked = 90%
- Spaces bar system = warm edge no metallic, Tri-seal/Super spacer desiccant impregnated
- Toughened to BS EN 12150
- Manufactured to BS EN1279 Part 2 & 3
- Structural Frame = A satin black durable polyester powder coated aluminium integrated upstand featuring a two part (inner/outer) profile joined by resin thermal breaks creating a triple cavity and expanded polystyrene insert from added insulation



ROOF maker
 1 Pinfold Road , Thurmaston
 Leicester, LE4 8AS
 Tel: 0116 269 6297
 Fax: 0116 269 6291
 Email: sales@roof-maker.co.uk

Title: HINGED OPENER SKYLIGHT - PRODUCT SPECIFICATION

THIS DRAWING IS FOR REFERENCE ONLY. PLEASE REPORT ANY DISCREPANCIES TO THE DESIGNER BEFORE ANY WORKS COMMENCE.
 ALL DIMENSIONS TO BE CHECKED ON SITE BEFORE ANY WORKS COMMENCE.

Reference: RM-Hinged open	Scale: Approx. 1:2 @ A4
Date: 16/02/2017	Revision No: B
Drawn: TH	Checked SS