

# ROOF MAKER

WORLD CLASS ROOFLIGHTS



PRODUCT SPECIFICATION AND INSTALLATION GUIDE

TRIPLE GLAZED FIXED FLAT ROOFLIGHT (WITH BLACKOUT BLINDS)

## TRIPLE GLAZED FIXED FLAT ROOFLIGHT WITH BLACKOUT BLINDS: PRODUCT SPECIFICATION AND INSTALLATION GUIDE

---

### CONTENTS

- **PAGE 2** PRODUCT SPECIFICATION CROSS SECTION DRAWING
- **PAGES 3-6** STEP BY STEP INSTALLATION GUIDE
- **PAGE 7** ROOF CROSS SECTION FITTING GUIDE
- **PAGE 8** BLACKOUT BLIND CORD CONFIGURATION GUIDE (*outlines how many support cords will be visible on your blackout blinds*)
- **PAGES 9-14** CONNECTING YOUR REMOTE-CONTROLLED BLACKOUT BLIND (*wiring guide for your blackout blinds*)

## TRIPLE GLAZED FIXED FLAT ROOFLIGHT: STANDARD PRODUCT SPECIFICATION

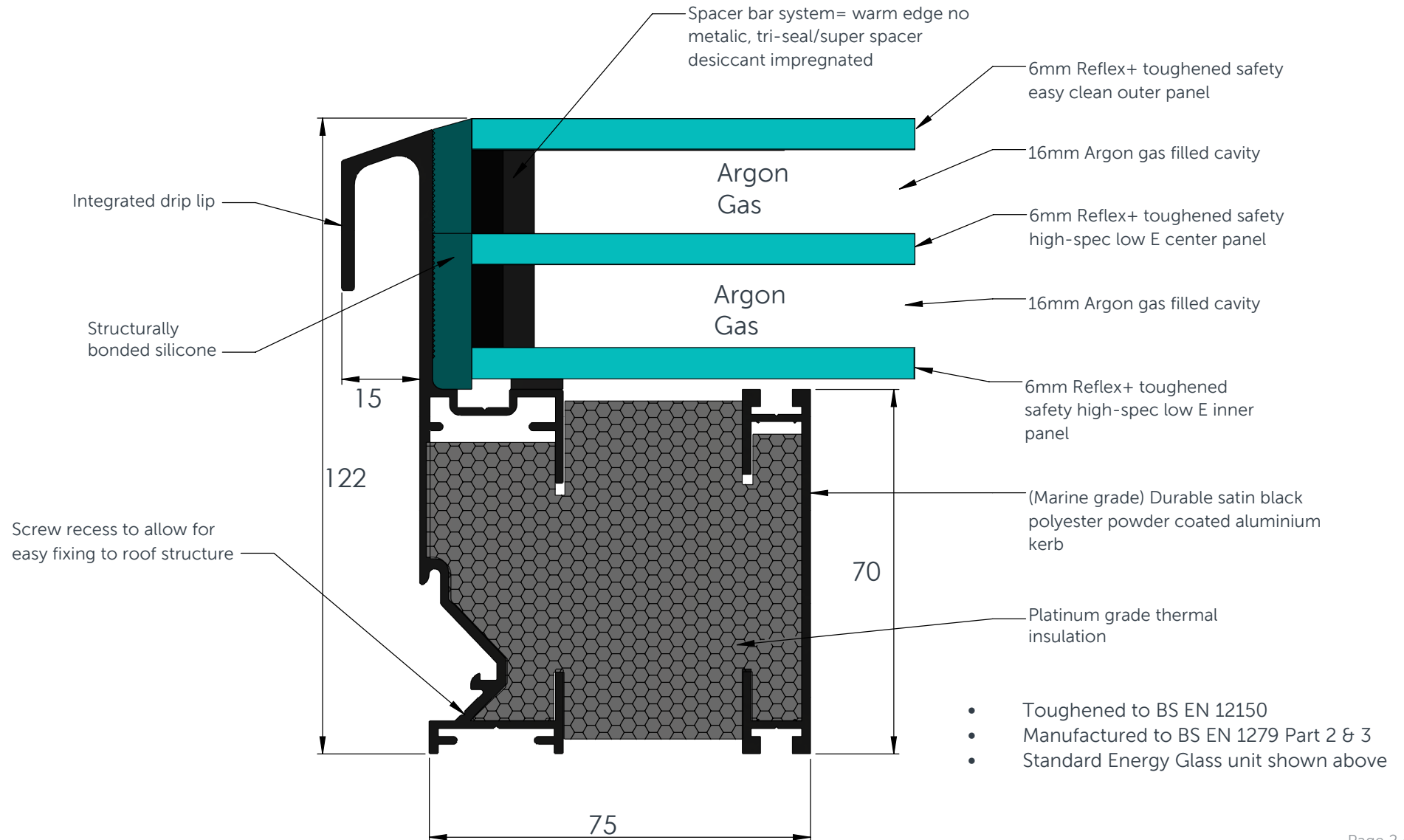

## TRIPLE GLAZED FIXED FLAT ROOFLIGHT: INSTALLATION GUIDE

### ON DELIVERY OF YOUR NEW FIXED FLAT ROOFLIGHT, YOU WILL RECIEVE;

- Your Fixed Flat Rooflight

### IN ADDITION TO YOUR NEW FIXED FLAT ROOFLIGHT, YOU WILL NEED;

- Silicone Adhesive Sealant (high quality; Dow Corning 791 recommended)
- Drill, bits and screws as required
- Materials to prepare a timber kerb

***Please take precaution when moving heavy objects and working at height. Be sure to use the correct equipment. Guide weights based on size, are shown on the chart to the right.***

GUIDE WEIGHTS (Triple Glazed)	
Size (mm)	Weight (kg)
400x400	20
700x700	43
1000x1000	75
1500x1000	105
2000x1000	135
2500x1000	165
3000x1000	195
1500x1200	122
2000x1200	157
2500x1200	192
1500x1400	139
2000x1400	179
3000x700	148

*PLEASE NOTE - weights stated can vary and work to a +/- 10% tolerance. We can provide weights for sizes not listed.*

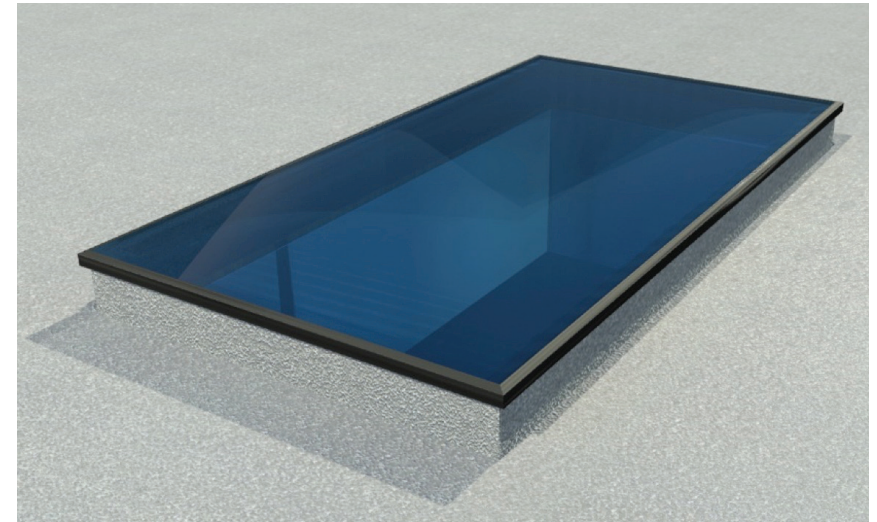

### INSTALLATION GUIDE

Make sure to read through all steps and understand all requirements before beginning the installation.

## STEP ONE

### PREPARE A TIMBER KERB FOR YOUR ROOFLIGHT

Prepare a 75mm width timber kerb for your rooflight. This should be a minimum of 25mm in height from the finished roof level. The internal dimensions of your kerb should match the internal dimensions of the rooflight/size ordered.

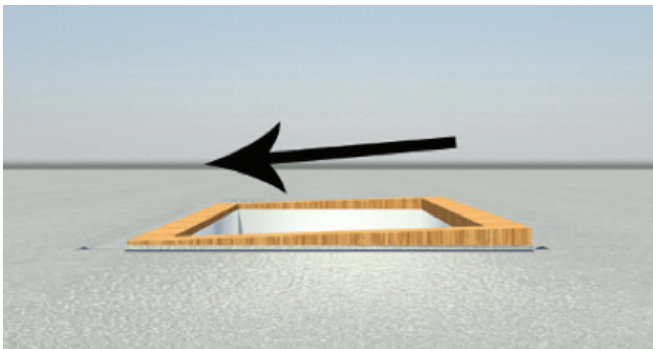

Your Fixed Flat Rooflight needs to be pitched at a minimum of 5° to allow water run-off. If your roof does not have this pitch, build the angle into your timber kerb. We recommend that you run the fall across the 'width' or 'shorter side' of the rooflight when building an angled kerb, as the fall will be less noticeable, which will improve the aesthetics when fitted.

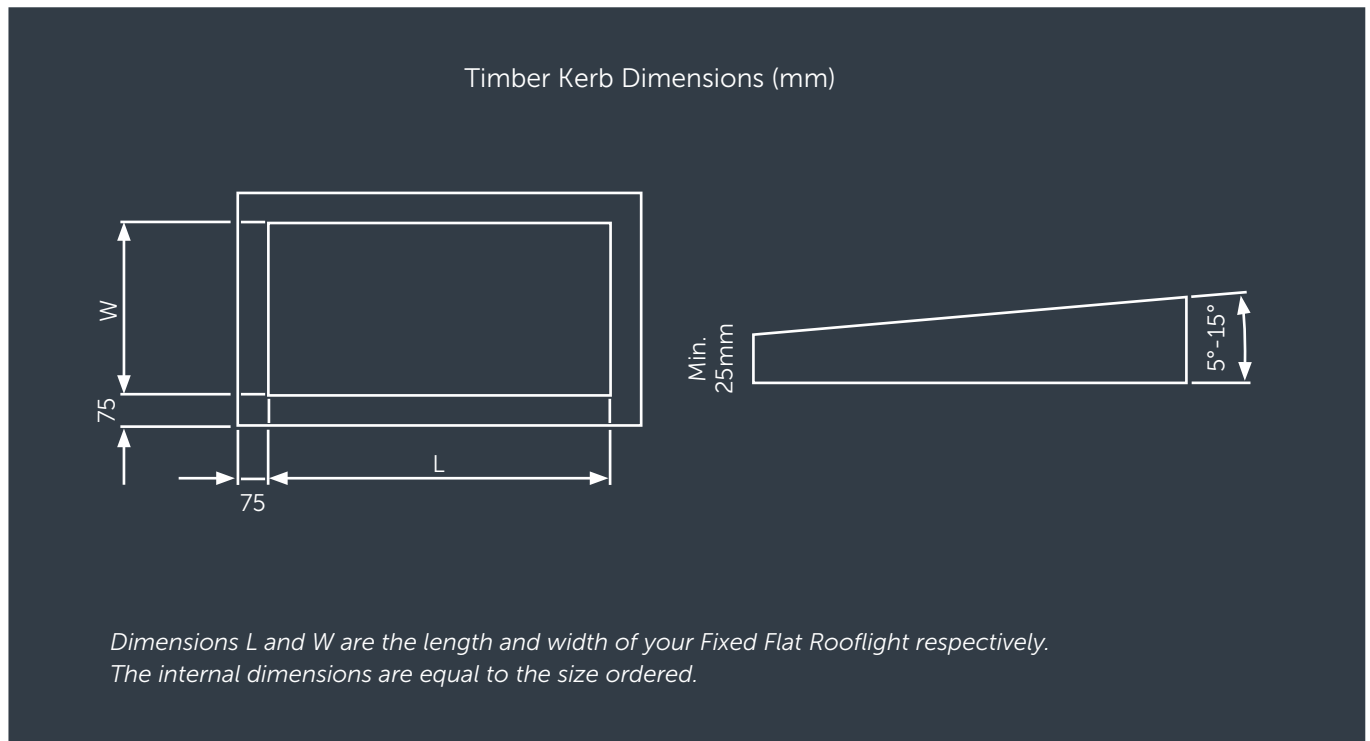

# ROOF MAKER

WORLD CLASS ROOFLIGHTS

Call us: 0116 269 6297  
Mon-Fri 9-5pm

## STEP TWO

### APPLY SILICONE TO YOUR KERB

Apply a generous bead of silicone around the top face of the kerb, as shown. The bead of silicone should be applied approximately 20mm from the internal edge.

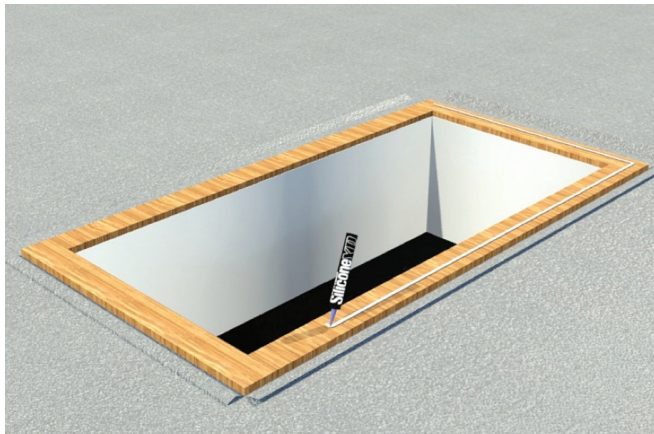

## STEP THREE

### POSITION THE ROOFLIGHT

Bring your Fixed Flat Rooflight into position. Align the rooflight so that it is centered on the aperture.

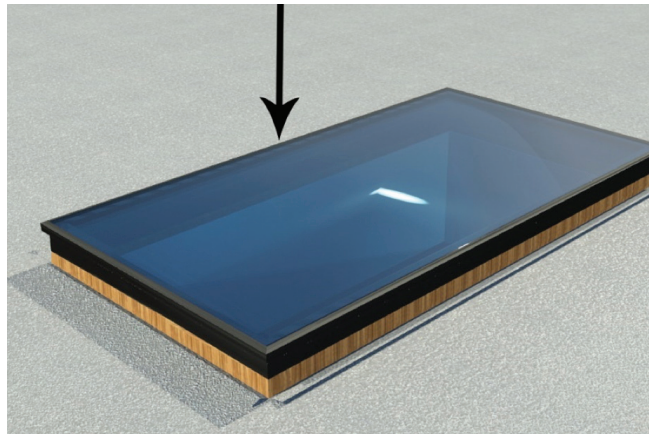

## STEP FOUR

### SECURE THE ROOFLIGHT TO THE KERB

Use the recess in the rooflight upstand to position the screws. Drill a pilot hole appropriate for your chosen screw diameter, and fix the frame with screws in the indicated positions: 100mm from each corner, and in the centre of the long sides.

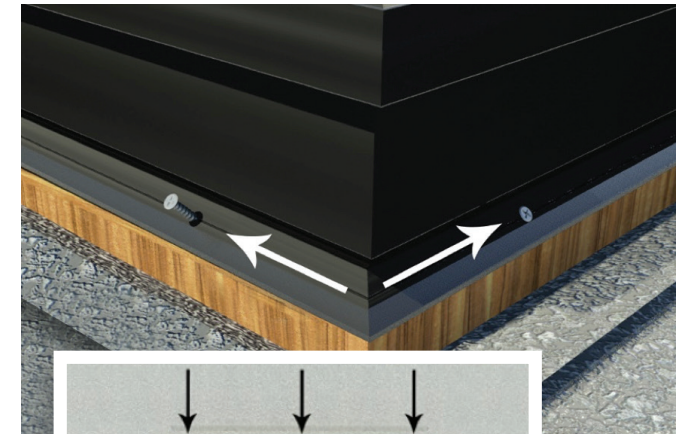

# ROOF MAKER

WORLD CLASS ROOFLIGHTS

Call us: 0116 269 6297  
Mon-Fri 9-5pm

## STEP FIVE

### A: SEAL THE ROOFLIGHT WITH THE ROOF MEMBRANE

Seal your flashing/roof membrane up the side of the rooflight, tucking it up underneath the dedicated drip overhang. When using a torch to seal roof membrane, cut material to the suitable size, fold back and apply heat to the sheet, away from the rooflight to avoid damage. Pre-heated membrane can then be bonded to the side of the rooflight.

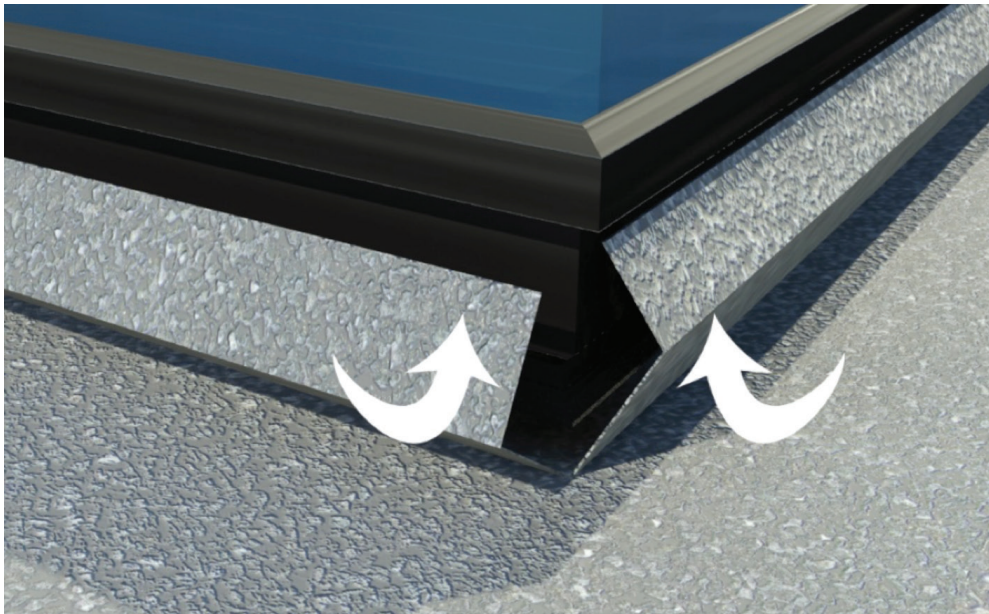

### B: WHEN USING GRP ROOF FINISH

When using GRP to finish roof, silicone bond a 4mm plywood border around the upstand and kerb, this will provide a more suitable surface for the GRP layer to adhere to.

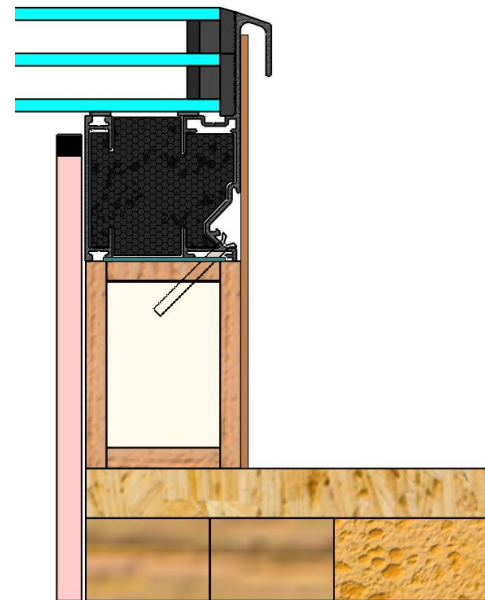

For plastering finish guidelines, please follow the roof section fitting guide, included at the end of this document.

Congratulations! Your Fixed Flat Rooflight is now installed.

## ROOF SECTION FITTING GUIDE - TRIPLE GLAZED

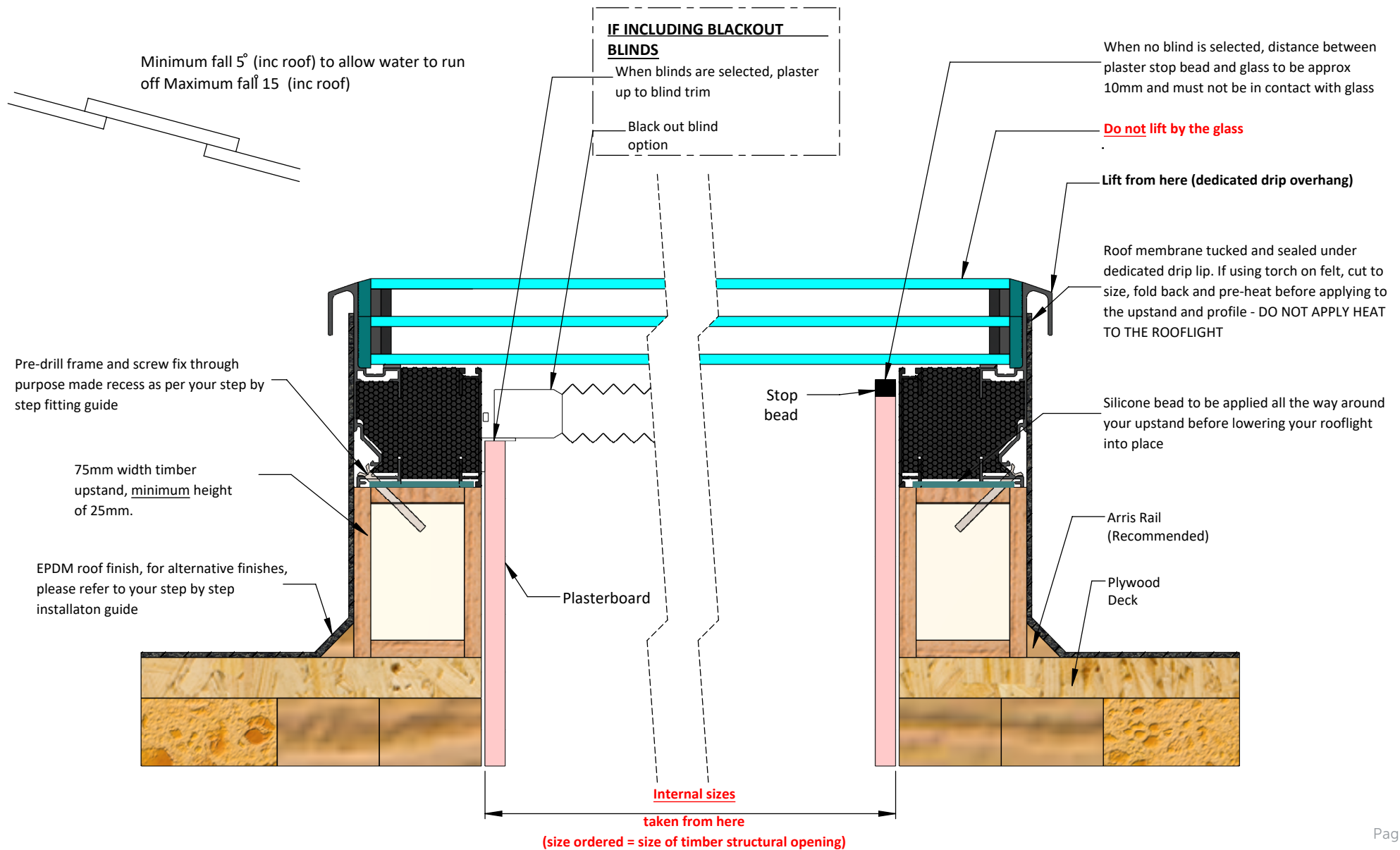





## BLACKOUT BLIND CORD CONFIGURATION GUIDE

### REFERENCE: PROPOSED CORD & NYLON CONFIGURATION PER ROOF BLIND

KEY:

-  Spooling cord – this cord travels through the central section of the fabric. Cords are paired together as an 'extend & return' system. Cord pairs are spaced 20mm apart. Spooling cords are visible when the blind fabric is compressed closed.
-  Support nylon – this semi-transparent nylon cord is fitted to provide fabric support. Nylon cords are visible when the blind fabric is compressed closed.

Motor position is defined as looking at the underside of the headrail where the motor and cord spooling componentry are exposed.

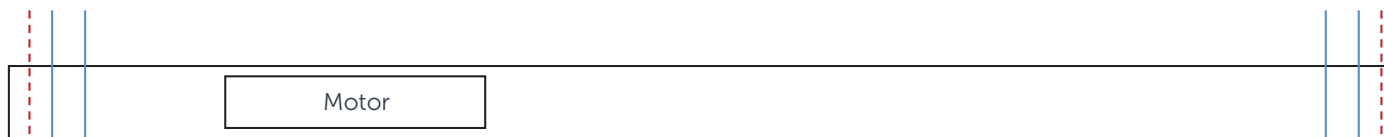

THIS SET UP APPLIES TO ALL ROOF BLINDS 500MM TO 699MM WIDE



THIS SET UP APPLIES TO ALL ROOF BLINDS 700MM TO 1100MM WIDE



THIS SET UP APPLIES TO ALL ROOF BLINDS >1100MM TO 1400MM WIDE



THIS SET UP APPLIES TO ALL ROOF BLINDS >1400MM TO 2000MM WIDE

## CONNECTING YOUR REMOTE-CONTROLLED BLACKOUT BLIND



### INTRODUCTION

Thank you for purchasing a blackout blind with your new rooflight. This guide will explain how to install your remote-controlled blackout blind.

### WHAT COMES WITH MY BLACKOUT BLIND?

- Blind and motor housing (factory fitted to your rooflight)
- White perimeter blind trim (factory fitted to your rooflight)
- 1 x 2400mm extension cable (factory fitted to your rooflight)
- 1 x boxed, Somfy remote-control. This will be given to you when your rooflight is delivered.
- 1 x boxed, Somfy 3 pin power adapter with 3000mm cable. This will be given to you when your rooflight is delivered.



## STEP ONE

PREPARATION IS REQUIRED IN THE CEILING VOID OF THE ROOM BELOW YOUR ROOFLIGHT IN ORDER TO PROVIDE A POWER SOURCE TO YOUR BLIND. THIS GUIDE COVERS EACH STEP REQUIRED TO COMPLETE THE SET-UP.

The blackout blind is factory fitted to your rooflight and will be in place when you take delivery of your unit. On the inside of your rooflight, you will see a white surround trim, fitted to the internal perimeter of the built-in upstand/frame. When the blind is fully retracted the blind motor housing will be clearly visible at one end. You will also see guide cables extending from one side to the other. These run the length of the rooflight, with the number and arrangement varying dependent on the size of the blind.

When positioning your rooflight, be careful not to catch these cables or pull them with any force..

ILLUSTRATION SHOWING THE UNDERSIDE OF A LUXLITE™ ROOFLIGHT WITH A BLIND

### Motor housing

Located at the end where your blind folds back.

### Power cable

The electric cable will be located at the same end as the motor housing.

### Guide cables

Quantity and arrangement will be dependent on the size of your unit.

White perimeter blind trim.

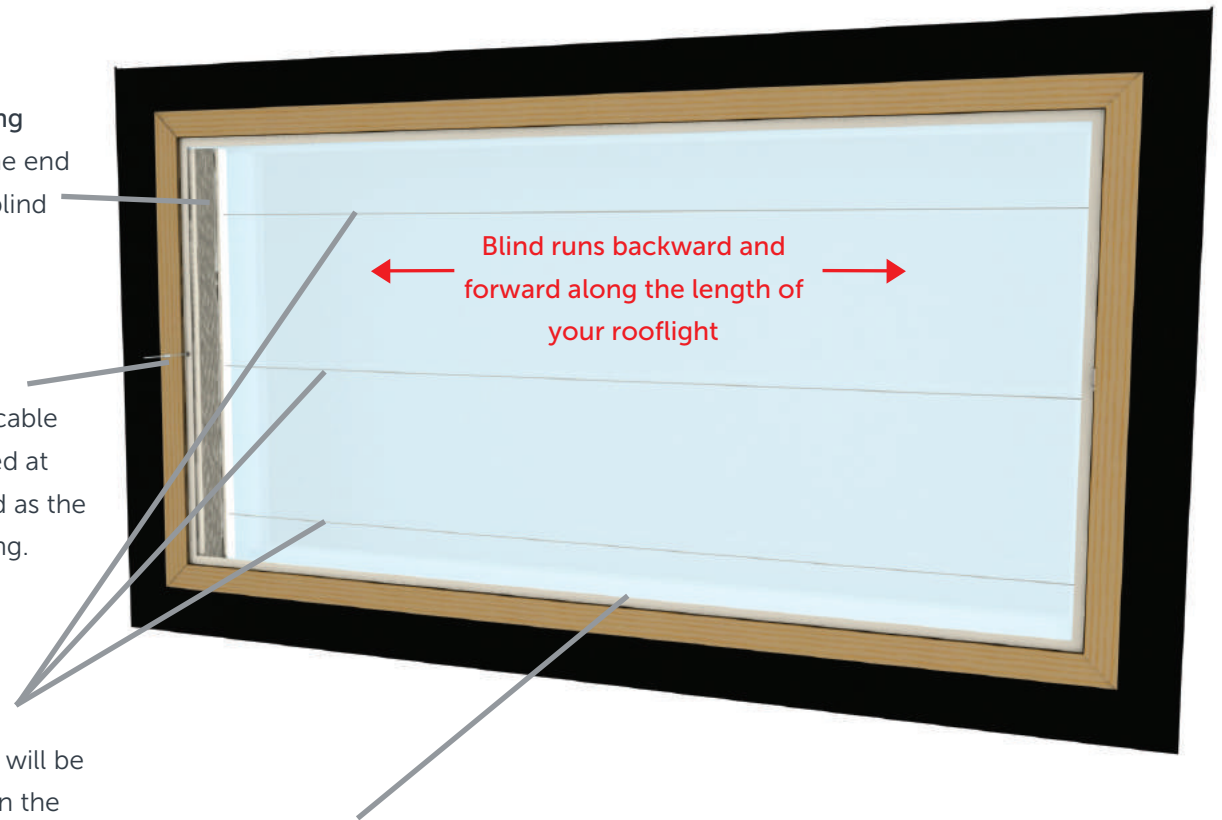

## STEP TWO

### TO POWER THE BLINDS.

A standard 3 pin plug needs to be located in your ceiling void area, within 4000mm of the blind motor.

We recommend creating an access panel so you can easily reach the installed electronics at a later date if required.

We advise that you do not plaster the ceiling in the room below until the rooflight is fitted and the blinds have been wired in. This will provide a clear area to work, allowing you to make last minute adjustments and avoid the blind cables being stretched unnecessarily if you need to achieve more slack.

The blind will move forwards and backwards as the arrows indicate.

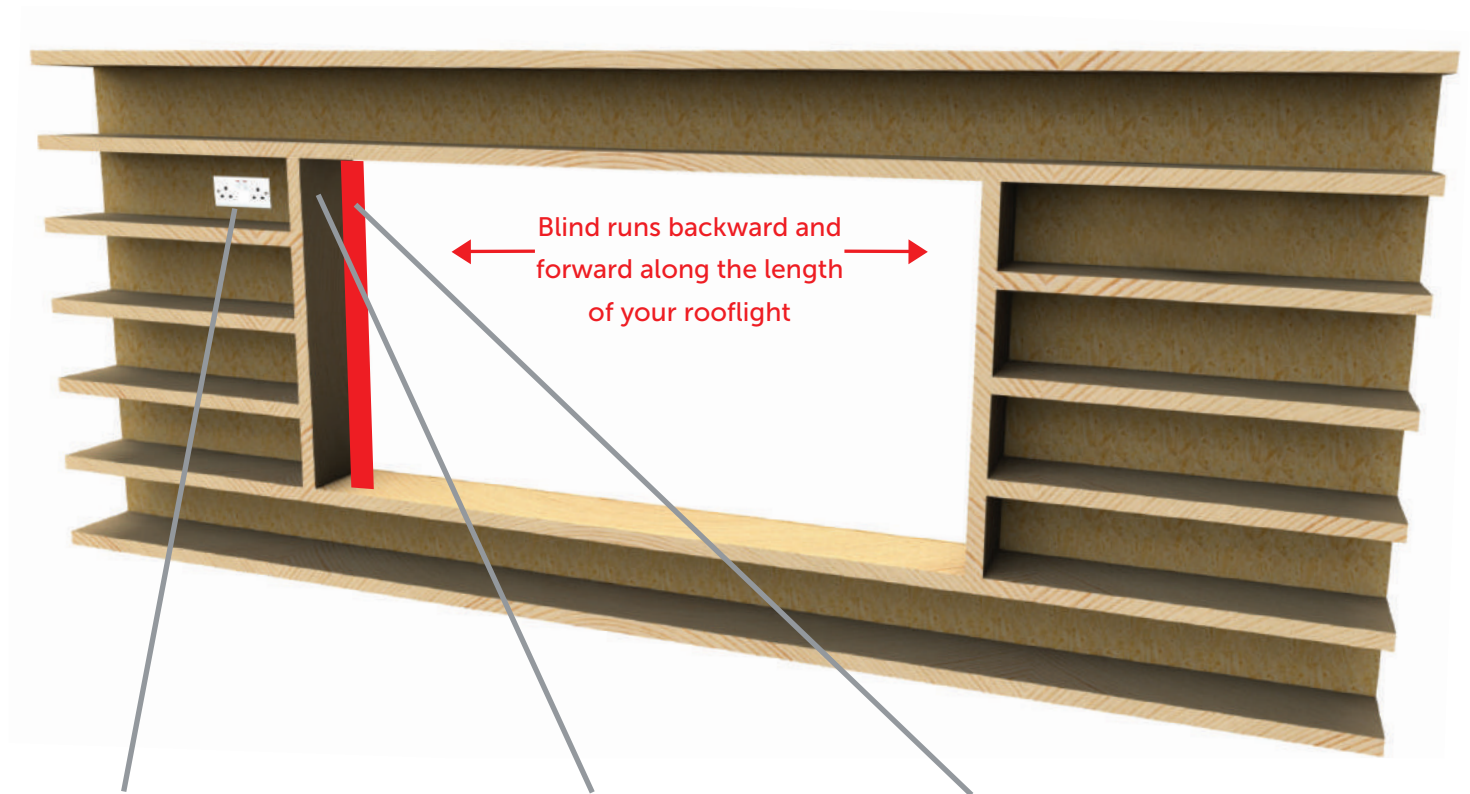

Situate the plug socket within 4000mm of the blind motor.

Create an access panel, so you can reach the electronics post installation.

Location of blind motor when installed.

## STEP THREE

### YOU ARE NOW READY TO INSTALL YOUR ROOFLIGHT.

Once your rooflight has been installed, you will be ready to connect your blinds to your power source. You will see the coiled electrical cabling below your blind motor housing. The cable feeds through a pre-drilled hole in the white perimeter blind trim, up to the blind motor. This is the 2400mm extension cable. Unwind the cable, ensuring you do not allow the connection in the wiring to be pulled out of the hole.

Run the cable straight down the reveal.

**WARNING:** You must visibly mark where you have run the wire, to avoid damaging the cable with screws or nails when you fix the plasterboard.

Once you have run the cable up to the joist/rafter, drill a hole through the joist/rafter so you can run the cable into the ceiling void, where you have positioned your 3 pin plug.

### THE WIRE CONNECTION MUST STAY ABOVE THE PERIMETER TRIM AS YOU MAY NEED TO LOCATE IT AT A LATER DATE.

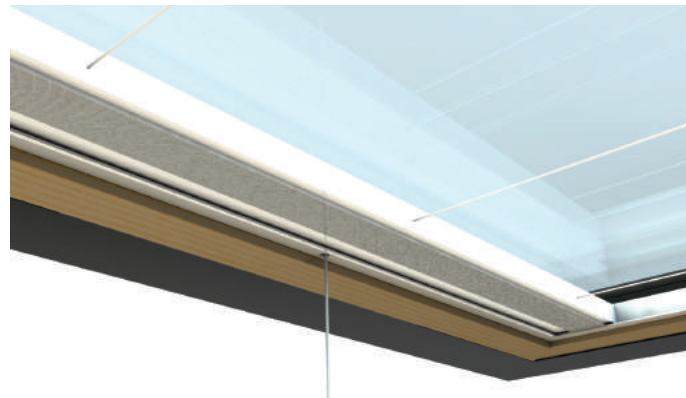

Cable coming through trim, no connection visible.

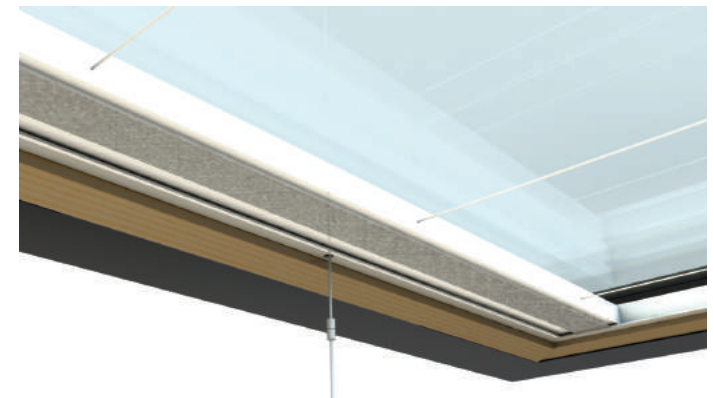

Cable coming through trim with connection visible.

## STEP FOUR

### CHANNEL INTO YOUR TIMBER.

You now need to notch a channel into your timber reveal, which will run the length from the hole you have just drilled to the hole where the cable comes through, in the white perimeter blind trim. Running the wire in this channel will ensure your plasterboard can fit flush to the timber. Please ensure the power source is located within 4000mm of where your blind motor will be positioned.

When you have run the cable from your blind into the ceiling void area, through the drilled hole, take the 3000mm power adapter cable provided and connect the 2 cables together. This is a small male/female 'push and click' connection.

Next, plug in the adapter to your 3 pin plug socket that you have located in the ceiling void. Your remote-controlled blackout blind is now connected.

The Somfy remote-control provided with your blind has been synchronised in the factory, so will work as soon as the blind is connected.

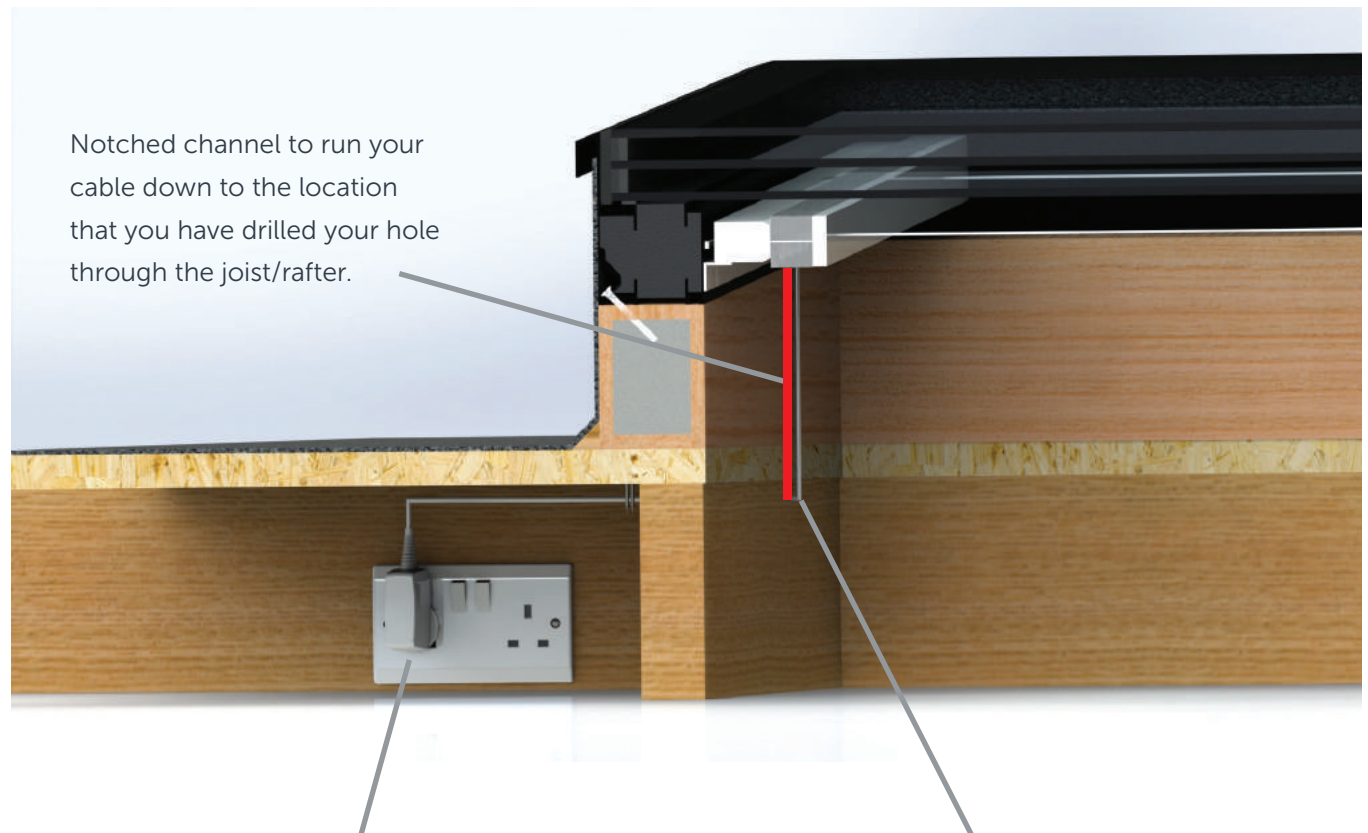

Notched channel to run your cable down to the location that you have drilled your hole through the joist/rafter.

Once you have fed the cable through to the void area in your ceiling, connect it to the 3000mm plug adapter cable provided.

Hole in your joist/rafter to feed your cable through to where you have located your 3 pin plug.

## STEP FIVE

### PLASTERING. PLEASE ENSURE YOUR BLIND IS FULLY OPERATIONAL BEFORE PLASTERING.

Plaster the ceiling in the room below and the reveals that lead up to the rooflight. The white perimeter blind trim gives you a perfect surface to plasterboard and wet plaster into.

We advise that you cover the retracted blind and motor housing with low adhesive masking tape or equivalent, to prevent you soiling the blinds when applying your wet plaster.

At this stage, you can incorporate an access panel into your ceiling or reveal leading up to the rooflight as mentioned previously.

**YOUR BLIND INSTALLATION IS NOW COMPLETE. WE HOPE YOU ENJOY YOUR NEW ROOFLIGHT WITH BLACKOUT BLINDS**



When you have plastered your reveals leading up to the rooflight, you have the option of installing an access panel in this area.