

ROOF MAKER

WORLD CLASS ROOFLIGHTS

Threshold options - 150mm cill

All measurements in mm

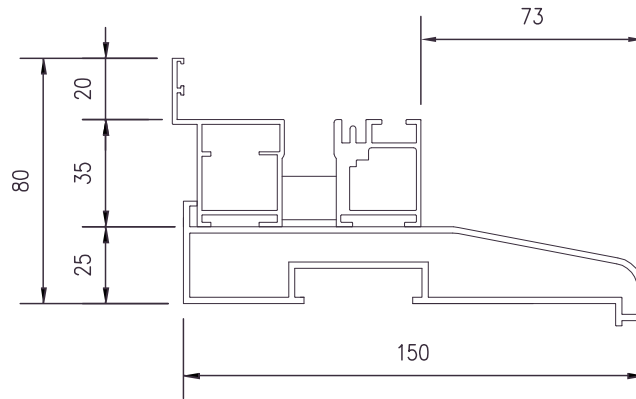

Standard threshold with 150mm cill

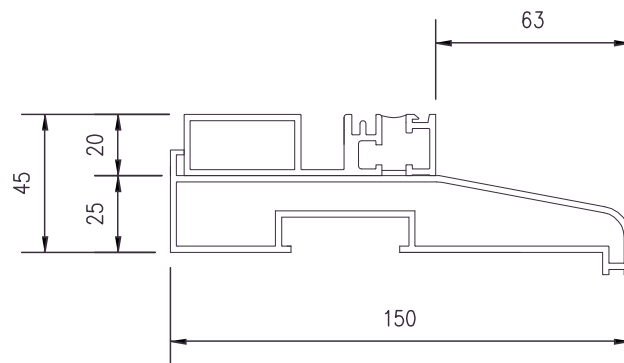

Low threshold with 150mm cill

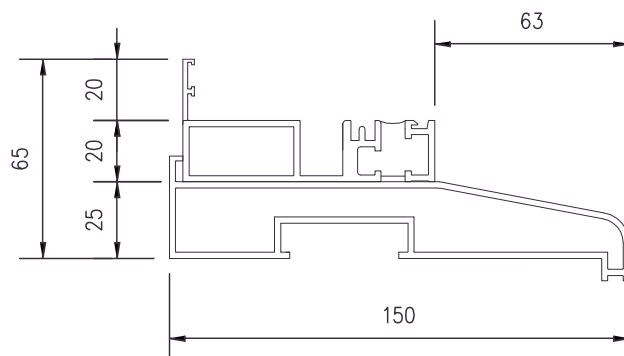

Low threshold with rebate and 150mm cill

ROOF MAKER

WORLD CLASS ROOFLIGHTS

Threshold options - No cill

All measurements in mm

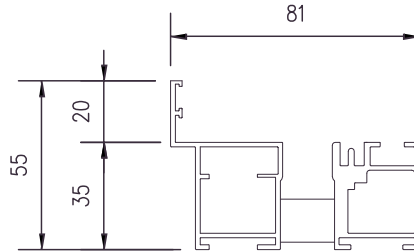

Standard threshold - no cill

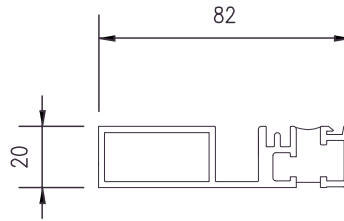

Low threshold - no cill

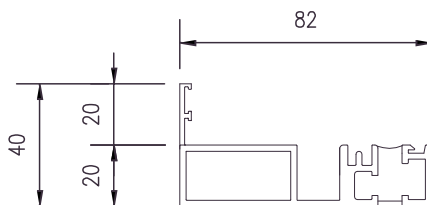

Low threshold with rebate - no cill

ROOF MAKER

WORLD CLASS ROOFLIGHTS

Thermfold® Aluminium Bifold Doors

Our Thermfold® Bifold Door system features our high performance reflex® glass units along with hardware from Mila combined with Cortizo system components – for a door system you can really be proud of.

These high performance bifold doors are perfect for exterior spaces such as patios and are designed to match our minimalistic aluminium powder coated rooflight range with reflex® glass and an industry-leading 10-year unit seal warranty.

- Our Thermfold® aluminium bifold doors feature Roof Maker's very own high-performance reflex® glass units, tested to BS EN1279 parts 2 & 3.
- Marine grade powder coated and fully thermally broken aluminium frame
- Choice of triple or double glazed with Ug-values as low as 1.1w/m2k
- Available in configurations up to 14 panels wide
- Class 4 Air permeability
- Class 9A Water tightness
- Class A3 Wind resistance
- Security tested and passed to PAS24

SPECIFICATIONS

Finish	Powder coated to marine-grade quality.
Hardware	Complete customisation - specify the colour of your handles and hardware.
Threshold	Optional low-threshold feature to reduce the risk of tripping.
Trickle Vent	Bar or leaf trickle vent options.



Frame width:	55mm
Frame depth:	73mm inside to outside 120mm
Glass possibilities :	28mm double glazing units & 32mm triple glazed units
Door profile thickness	1.8mm
Max sash height:	2500mm
Max sash width:	1200mm
Max sash weight:	120kg
Thermal properties	From 1.1 W/m2k
Air:	Class 4
Wind:	Class A3
Water:	Class 9A

ROOF MAKER

WORLD CLASS ROOFLIGHTS

Cross Sections



Standard threshold detail

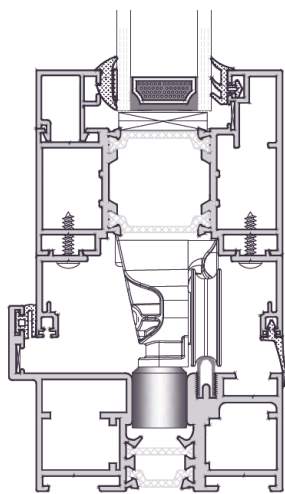

Low threshold detail

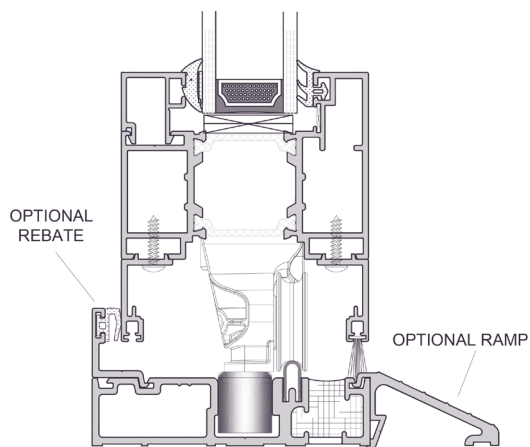

Head detail

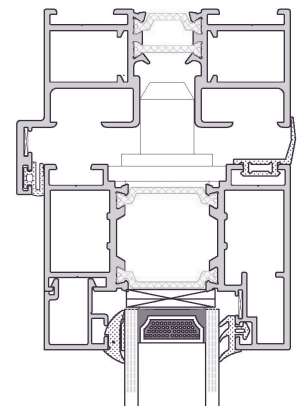

Intermediate detail integrated lock

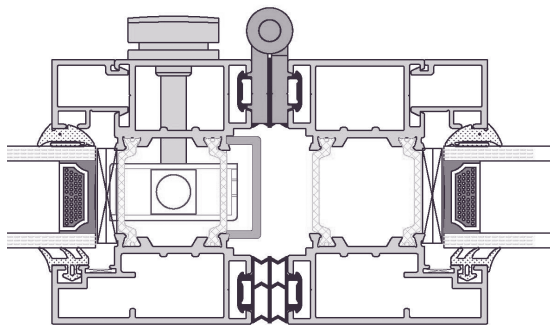

Outer frame detail with adjustable jambs

